



UPSHUR COUNTY COMMISSIONERS COURT
GILMER, TEXAS

February 28, 1983

Commissioners Court met in Special Session with all members present.

Judge Dean read the minutes of the February 21, 1983 meeting. Motion was made by J. W. Meadows seconded by Delmo Lawson for the minutes to stand as read. Motion carried. Copy attached.

District Attorney Investigator, Tom Wilcox met with the Court asking permission to go to the Investigator School in Asutin, Texas March 27-April 1. He also requested the County to pay the fees for the school in the amount of \$85.00, with \$35.00 of that amount to be reimbursed by the State, and the County to pay his membership dues in the Texas District and County Attorneys Association. Motion was made by Charles Still seconded by Delmo Lawson to approve these request. Motion carried.

Motion by Charles Still seconded by J. W. Meadows to approve an amendment to a plat of the Bond Addition for recording purposes only. Motion carried.

Motion by Charles Still seconded by J. W. Meadows to approve a Permit Application by W. E. Vaughn, Jr. to place a driveway within the ROW of Bamboo Road. Motion carried. Copy attached.

Motion by Charles Still seconded by Delmo Lawson to approve a Permit Application by Pritchett Water Supply Corp. to place a water line within the ROW of Lemon Trail. Motion carried. Copy attached.

Motion by J. W. Meadows seconded by Delmo Lawson to approve a Permit Application by Hubert W. Green to place a culvert within the ROW of Daffodil Road. Motion carried. Copy attached.

Motion by Charles Still seconded by Delmo Lawson to approve a Special Road Use Agreement by Haughton Timber Co. for use of Bamboo, Birch, and Beach Roads. That portion of Bamboo from 1002 to Birch and Beach will not be used. Permitted only to use west end of Bamboo. Motion carried. Copy attached.

Motion by J. W. Meadows seconded by Delmo Lawson to approve Ann Dawson as a new employee in the County Auditor's Office. Motion carried. Copy attached.

Motion by Charles Still seconded by J. W. Meadows for all the names to be added to the Historical Commission original list that Judge Dean read to the Court. This list will be given to the Clerk at the next Court meeting, to be placed in the minutes. Motion carried.

Motion by Charles Still seconded by J. W. Meadows to consider paying all bills due and payable. Motion carried. Copy attached.

Court closed for an Executive Session.

Eward Dean

JUDGE DEAN

Delmo Lawson

COMMISSIONER, PCT.#1

J.W. Meadows

COMMISSIONER, PCT.#2

Charles Still

COMMISSIONER, PCT.#3

Paul Dawson

COMMISSIONER, PCT.#4

PERMIT APPLICATION FOR
USE OF UPSHUR COUNTY RIGHT OF WAY

TO: THE UPSHUR COUNTY COMMISSIONERS COURT
COUNTY OF UPSHUR
GILMER, TEXAS

PRECINCT 3
DATE Feb. 21, 1983

Formal notice is hereby given that W. E. Vaughn, Jr.
whose principal address is Rt. 1 Box 81, Big Sandy, Texas 75755
does propose to place a ~~culvert~~ installation DRIVEWAY
within the ROW of County Road Bamboo Road
as follows:

The location and description of the proposed lines or
appertenances is more fully shown by three (3) copies of
drawings attached to this application.

All work will be as directed by the County Commissioner or
his designate in full accordance with Upshur County Road &
Bridge Department policies and specifications.

Proposed construction will begin, if approved, on or after
_____ day of _____, 19____.

NAME W. E. Vaughn Jr.

TITLE _____

ADDRESS _____

Approved
2-28-83

PERMIT APPLICATION FOR
USE OF UPSHUR COUNTY RIGHT OF WAY

TO: THE UPSHUR COUNTY COMMISSIONERS COURT
COUNTY OF UPSHUR
GILMER, TEXAS

PRECINCT 3
DATE 2-14-83

Formal notice is hereby given that FRITCHETT WATER SUPPLY CORP.
whose principal address is P. O. Box 567 Gilmer, Tx. 75644
does propose to place a water line
within the ROW of County Road LEMON TRAIL
as follows:
To cross road from South to North with 1 in. PVC incased in 1 1/2 in.
PVC to serve one meter: MONAHE GAGE
ODELL

The location and description of the proposed lines or appertenances is more fully shown by three (3) copies of drawings attached to this application.

All work will be as directed by the County Commissioner or his designate in full accordance with Upshur County Road & Bridge Department policies and specifications.

Proposed construction will begin, if approved, on or after
20 day of Feb., 19 83.

NAME J. K. Gage

TITLE OPERATOR

ADDRESS Rt. 2 Box 813
Big Sandy, Tex. 75755

[Handwritten Signature]
2-28-83

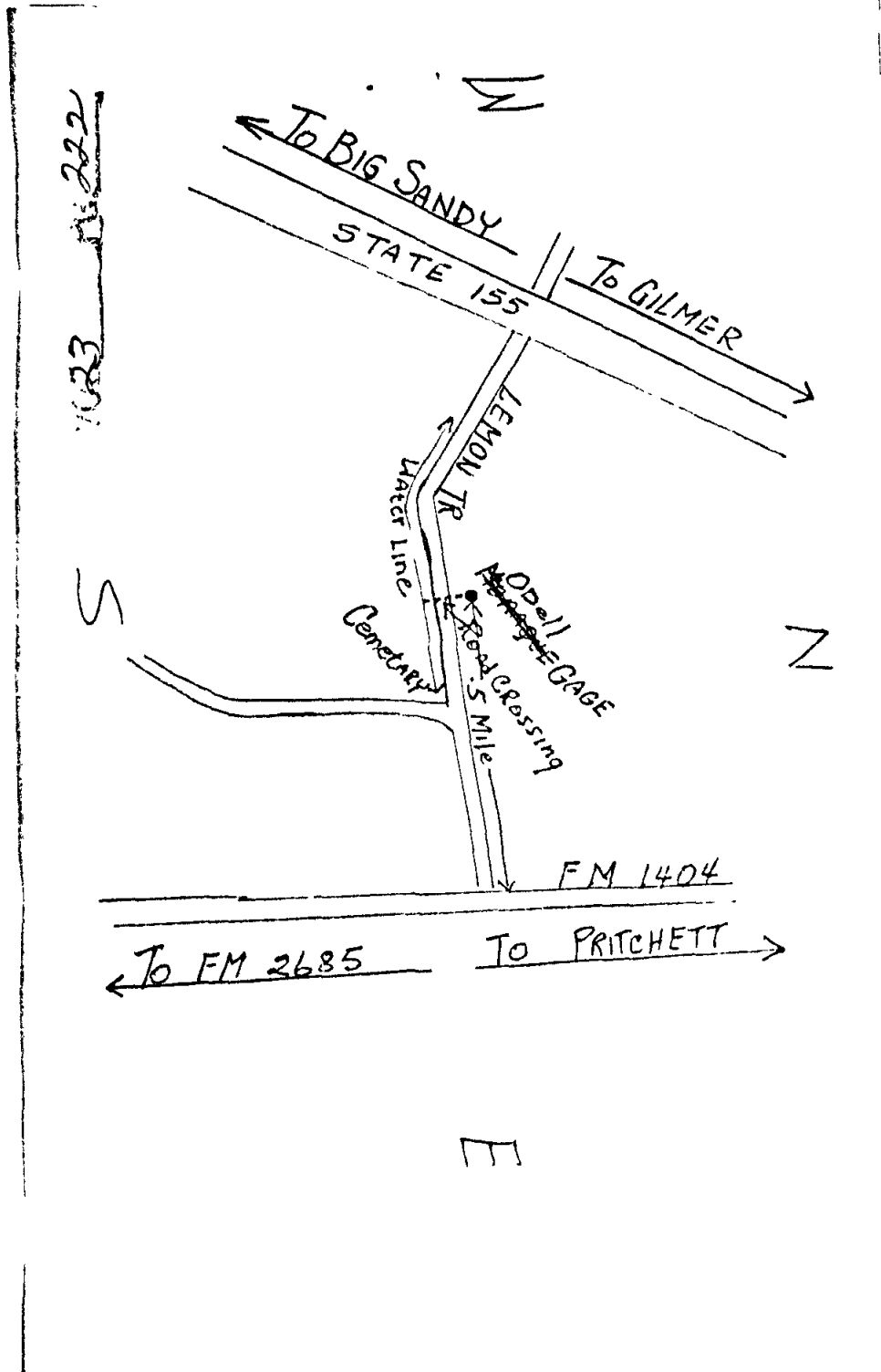

PERMIT APPLICATION FOR
USE OF UPSHUR COUNTY RIGHT OF WAY

TO: THE UPSHUR COUNTY COMMISSIONERS COURT
COUNTY OF UPSHUR
GILMER, TEXAS

PRECINCT 2
DATE Feb. 23, 1983

Formal notice is hereby given that Hubert W. Green
whose principal address is 1803 Clinton St., Longview, Texas 75604
does propose to place a culvert installation
within the ROW of County Road Daffodil Road
as follows:

The location and description of the proposed lines or appertenances is more fully shown by three (3) copies of drawings attached to this application.

All work will be as directed by the County Commissioner or his designate in full accordance with Upshur County Road & Bridge Department policies and specifications.

Proposed construction will begin, if approved, on or after _____ day of _____, 19____.

NAME Hubert W. Green

TITLE _____

ADDRESS _____

Approved
2-28-83

SPECIAL ROAD USE AGREEMENT CONTRACT

THE STATE OF TEXAS |
COUNTY OF UPSHUR | KNOW ALL MEN BY THESE PRESENTS

The undersigned, Haughton Timber Co., hereinafter referred to as First Party, enters into and makes an agreement with Upshur County Commissioner of Precinct No. 3, Upshur County, Texas, and in order to get material to market it is necessary to use a portion of Upshur County roads located in Precinct No. 3, over which Commissioner has jurisdiction and obligation to maintain in good repair and both parties being aware of possible damage to said roads as a result of hauling on and over same enter into the following agreement.

1.

First Party agrees to use only that section of (describe road) Bamboo, Birch and Beach Roads

that portion of Bamboo from 1002 to Birch & Beach will not be used - permitted only to use west end of Bamboo. 2.

First Party agrees to use its vehicles in such a manner as not to block or interfere with other traffic on said road so that said road will be open to travel by the public at all times.

3.

First Party agrees to grade, maintain and otherwise repair said road using its own equipment, labor and materials, if any needed, during the duration of time that First Party is removing logs from its lands located in Precinct No. 3, Upshur County.

4.

First Party agrees to put said road back into the same condition as it was prior to the commencement of hauling operations on the part of First Party.

5.

First Party agrees to post surety bond in the amount of _____ to Upshur County Commissioners Court to insure performance of agreement.

6.

Nothing herein shall be construed as a waiver by the Commissioner of the authority granted him by Article 6716, V.A.C.S., but the rights and authority granted the Commissioner by the terms of Article 6716, V.A.C.S. are expressly reserved by the Commissioner in the event First Party fails to abide by the conditions above set forth.

WITNESS our hands this the 28 day of February A.D. 19 83.

Ray Dean Houghton Timber Co.
FIRST PARTY
Josten Hall
Haughton Timber Co., P.O. Box 688,
Marshall, Texas 75670

Elmer Dean
COUNTY JUDGE

John Lawson
COMMISSIONER #1

Joe Meadows
COMMISSIONER #2

C. L. Hill
COMMISSIONER #3

Samuel
COMMISSIONER #4

TO: PAYROLL DEPARTMENT

PLEASE ENTER THE FOLLOWING CHANGE(S) IN YOUR RECORDS TO TAKE

EFFECT 8-1-83
(DATE & TIME)

EMPLOYEE Ann Dawson

SOCIAL SECURITY NO _____ CLOCK NO _____

VOL 23 - PG 226

THE CHANGE(S)

<input checked="" type="checkbox"/> CHECK ALL APPLICABLE BOXES	FROM	TO
<input checked="" type="checkbox"/> DEPARTMENT	Co A.	
<input type="checkbox"/> JOB		
<input type="checkbox"/> SHIFT		
<input type="checkbox"/> RATE		
<input checked="" type="checkbox"/>	875.00	

REASON FOR THE CHANGE(S)

- HIRED
- RE HIRED
- PROMOTION
- DEMOTION
- TRANSFER
- MERIT INCREASE
- UNION SCALE
- PROBATIONARY PERIOD COMPLETED
- LENGTH OF SERVICE INCREASE
- RE EVALUATION OF EXISTING JOB
- RESIGNATION
- RETIREMENT
- LAYOFF
- DISCHARGE

LEAVE OF ABSENCE FROM _____ (DATE) UNTIL _____ (DATE)

OTHER (EXPLAIN) _____

CHANGE AUTHORIZED BY [Signature] DATE 7-28-83

CHANGE APPROVED BY _____ DATE _____

GENERAL FUND

<u>CLAIM NO:</u>	<u>PAY TO:</u>	<u>CLASSIFICATION:</u>	<u>AMOUNT:</u>
515	Charles still	401-425	149.50
516	Keith Barber	401-425	277.12
517	J.W. Meadows	401-425	73.84
518	Everett Dean	401-425	239.86
519	Delmo Lawson	401-425	224.13
520	Paul Davis	401-425	68.18
521	Sandy Livengood	435-407	297.00
522	Wayne Toliver	435-407 NR	4,190.00
523	Harry R. Heard	435-407	500.00
524	Dwight Brannon	435-407	100.00
525	F. L. Garrison	435-407	500.00
526	Longview Mobilfone & Paging	455-416	23.50
527	Lanier Business Products	476-310	13.95
528	Patricia Harrison	476-413	350.00
529	Texas Co. & Dist. Attorney Asso.	476-425	60.00
530	Texas Co. & Dist. Attorney Asso.	476-472	25.00
531	IBM Corp.	495-460/605.14 770-720/605.14	1,210.28
532	Karmen Steelman	495-480	206.25
533	Wislon Distrubing Co.	510-332	113.16
534	City Of Gilmer	510-440/124.88 513-440/16.40	141.28
535	Arkla Gas	510-442/911.19 514-442/223.71	1,134.90
536	Swepco	513-441/78.97 514-441/94.28	173.25
537	Exxon USA	560-340	640.12
538	Mobil Oil Credit Corp.	560-340	20.15
539	Lewis Polgraph Service	560-441	65.00
540	Med Shop	630-337	15.64
513	Salary Fund	V-V	99,811.97
514	Gilmer National Bank	750-710	110,000.00
R & B # 1			
77	Salary Fund	611	5,989.81
78	Gilmer National Bank	750-710	69,000.00
79	J.C. Henderson	611-342	5.76
80	H.C. Wilson, Dsitribution	611-344	35.80
81	Willie Lee Willaams	611-346	174.00
R & B # 2			
85	Salary Fund	612-	5,382.64
86	Gilmer National Bank	750-710	80,000.00

VOL 03-11-83

R & B # 3

83	Salary Fund	613	8,319.35
84	Revenue Sharing	800-42	10,000.00
85	Long Motor Co. Inc.	613-350	71.15
86	Arkla Gas	613-442	33.26

R & B # 4

76	Salary Fund	614	7,800.00
77	Gilmer National Bank	750-710	24,000.00
78	Goodyear Service Store	614-342/200.05	230.05
		614-450/30.00	
79	Lonnie Johnson	614-346	74.00
80	Alma Simon & Ethel McGill	614-346	24.00
81	Chester Newsome	614-346	24.00

REVENUE SHARING

35	Gilmer National Bank	750-710	170,000.00
----	----------------------	---------	------------

DEBT SERVICE

15	Gilmer National Bank	750-710	22,000.00
----	----------------------	---------	-----------

R.O.W.

29	Gilmer National Bank	750-710	31,000.00
----	----------------------	---------	-----------

SALARY FUND

49	State Reserve Life Ins. Co.	780-256	31.40
50	Horace Morris	760-252	82.40

VOL 23
PR 239

VOL 23, PG 230

LONGVIEW
BANK & TRUST
LONGVIEW, TEXAS 75606

JACK M. FINLEY, INC.
DBA LAWYERS' TITLE AGENCY
GREGG AND UPSHUR COUNTY
OPERATING ACCOUNT
422 N. GREEN STREET 757-5118
LONGVIEW, TEXAS 75601

1415

3-3 19 83

88-2323/1119

PAY TO THE ORDER OF County Clerk, Upshur Co., Tx \$ 150.
ONE hundred SIXTY AND No/100 DOLLARS

THIS CHECK IS DELIVERED FOR PAYMENT ON THE FOLLOWING ACCOUNTS

Copies			
Plant upkeep			

Jack M. Finley

⑈001415⑈ ⑆111923238⑆ ⑈ 01 4657 9⑈